



© Pegasus Planning Group Limited. © Crown copyright and database rights OS 100042093. Promap. Licence number 100020449. EmapSite Licence number 010003873. Terms & Conditions @ pegasusgroup.co.uk

INDICATIVE PLANT SCHEDULE

WOODLAND MIX
Heavy standards. Planted on a staggered grid, min. 3m centres, in species groups of 3 to 5.

| PLANT SPECIES | SIZE (GIRTH AND HEIGHT) |
|--------------------|----------------------------|
| Acer campestre | RB 12-14 cm, 350-400 cm ht |
| Alnus glutinosa | RB 12-14 cm, 350-400 cm ht |
| Clarius betulus | RB 12-14 cm, 350-400 cm ht |
| Corylus avellana | B 80-100cm ht |
| Crateagus monogyna | B 80-100cm ht |
| Betula pendula | RB 12-14 cm, 350-400 cm ht |
| Betula pubescens | RB 12-14 cm, 350-400 cm ht |
| Fagus sylvatica | RB 12-14 cm, 350-400 cm ht |
| Malus sylvestris | RB 12-14 cm, 350-400 cm ht |
| Prunus avium | RB 12-14 cm, 350-400 cm ht |
| Quercus robur | RB 12-14 cm, 350-400 cm ht |
| Sorbus aria | RB 12-14 cm, 350-400 cm ht |
| Sorbus aucuparia | RB 12-14 cm, 350-400 cm ht |

HEDGEROW TREES

| PLANT SPECIES | SIZE (GIRTH AND HEIGHT) |
|------------------|----------------------------|
| Acer campestre | RB 12-14 cm, 350-400 cm ht |
| Betula pendula | RB 12-14 cm, 350-400 cm ht |
| Fagus sylvatica | RB 12-14 cm, 350-400 cm ht |
| Malus sylvestris | RB 12-14 cm, 350-400 cm ht |
| Prunus avium | RB 12-14 cm, 350-400 cm ht |
| Quercus robur | RB 12-14 cm, 350-400 cm ht |
| Sorbus aucuparia | RB 12-14 cm, 350-400 cm ht |

NATIVE MIXED HEDGEROW
Planted 5 plants per linear m, double staggered row

| PLANT SPECIES | SIZE | % |
|--------------------|----------------|----|
| Corylus avellana | B 80-100 cm ht | 20 |
| Crateagus monogyna | B 80-100 cm ht | 30 |
| Ilex aquifolium | 3L 40-60cm ht | 10 |
| Prunus spinosa | B 80-100 cm ht | 25 |
| Rosa canina | B 80-100 cm ht | 5 |
| Sambucus nigra | B 80-100 cm ht | 5 |
| Viburnum opulus | B 80-100 cm ht | 5 |

KEY

Site boundary

EXISTING

- Existing vegetation to be retained and protected
- Existing vegetation to be removed
- Stone wall to be retained
- Stone wall to be removed
- Water pipe
- Track beyond Site boundary

PROPOSED

- Native hedgerow trees
- Tree planting: Deciduous native mixed woodland, planted as Heavy Standards
- Native mixed hedgerow, new sections and gapping up of existing hedgelines
- Native shrub mix
- Mown grass. Seeded with Emorsgate EL1 Flowering Lawn or similar and approved
- Tussock grass - seeded with Emorsgate EM10 Tussock Meadow Mixture, or similar approved.
- Species rich grass, seeded with Emorsgate EGI General Purpose Meadow Mixture or similar and approved.
- Access road
- Easement

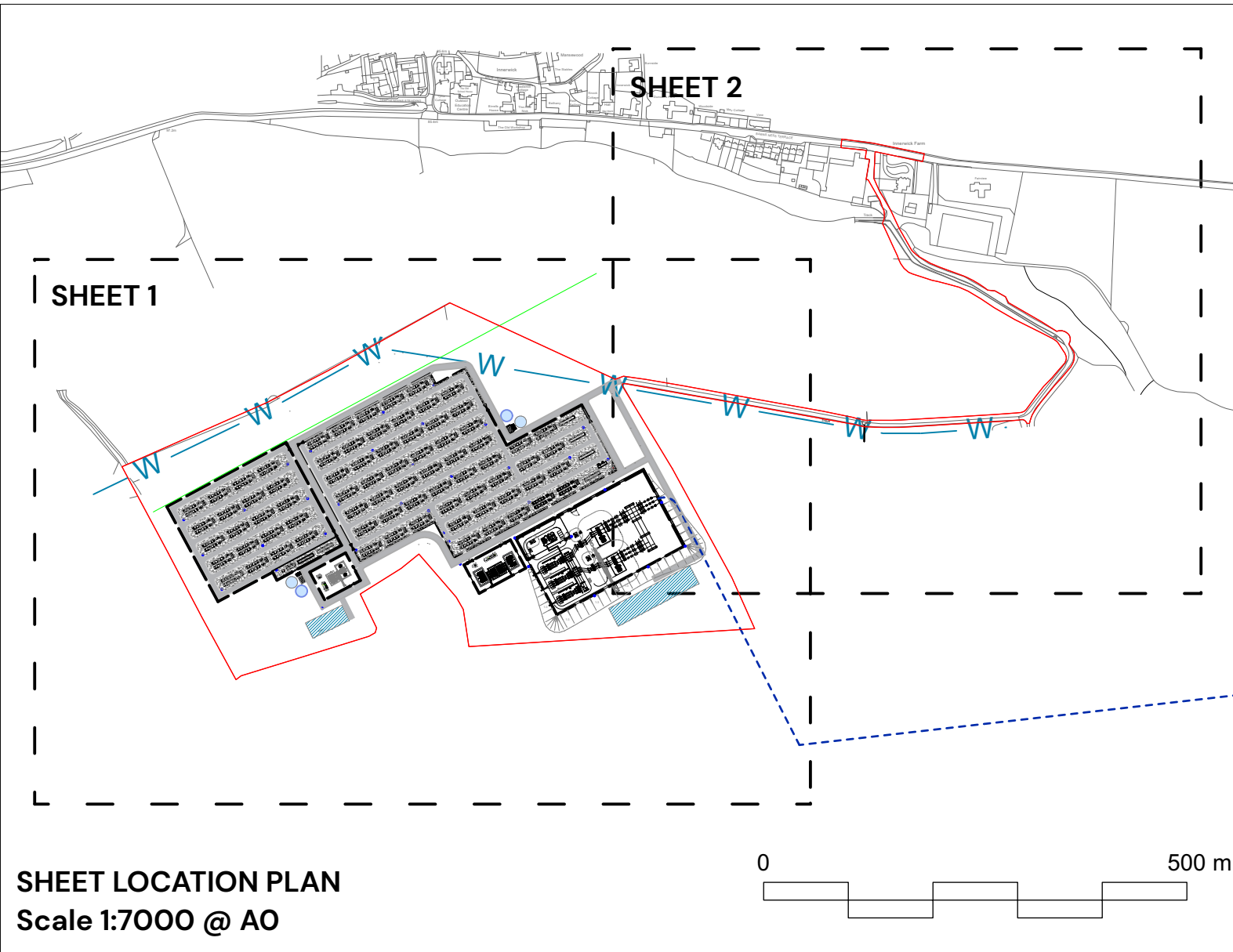

Key Considerations:
Minimum of a 10m wide landscape belt around the periphery of the site. Combining new native tree planting and native hedgerow planting to the north and native hedgerow planting and species rich 'Tussock' grass to the south. Additional hedgerow planting within the site interior, to the perimeter of the development. Proposed planting to comprise species of local provenance, with stock in accordance with seed zone 203 as described in Seed Sources for Planting Native Trees and Shrubs in Scotland (Forestry Commission Scotland 2006). Existing vegetation to perimeter of Site to be protected and retained as far as practicable in accordance with BS 5837:2012. Opportunities for biodiversity net gain. Emergency and maintenance access will be from the north east, off Barns Ness Terrace.

Landscape Masterplan

Braxbess Storage

Sheet 2 of 2

Client: Braxbess Limited
DRWG No: P23-0094_EN_0001_S2 REV: B
Drawn by : LB Approved by: KC
Date: 29/11/2023
Scale: 1:1000 @ A0



| | | | |
|-----|----------|-----|---|
| B | 17/01/24 | LB | Revised layout - minor landscape amendments |
| A | 03/01/24 | KCH | Addition of native shrub mix and minor landscape amendments |
| - | 29/11/23 | LB | First draft |
| Rev | Date | By | Note |